

CHICKEN CO-OP



Luxury Chicken Living

THE REVOLUTION

The chicken coop represents a complete re-thinking of the urban life of chickens. The renowned architects at RAAD have employed the finest materials and latest technologies to generate a unique vision through design.

Maximally efficient usage of material and assembly forms graceful living spaces for modern chickens. Flat stacking components are prefabricated by computer-driven routers. Each major component panel represents one necessary aspect of urban chicken life. With basic tools, the residence can be assembled using in less than one day.

Cutting edge design approaches place the Co-op at the forefront of sustainable building. All residences utilize passively heating and cooling systems. Solar power drives a fan to supplement passive systems throughout the summer. Hens are able to maximize their yield and productivity in optimal comfort year-round.



THE BUILDING

The Chicken Co-Op is constructed of routed exterior grade plywood and acrylic sheets. Then it is painted for long lasting durability.

TOTAL BUILT DIMENSION:
3' x 6'10" x 5'6"

TOTAL PACKAGE DIMENSION:
4'-3" x 7'-1" x 11"

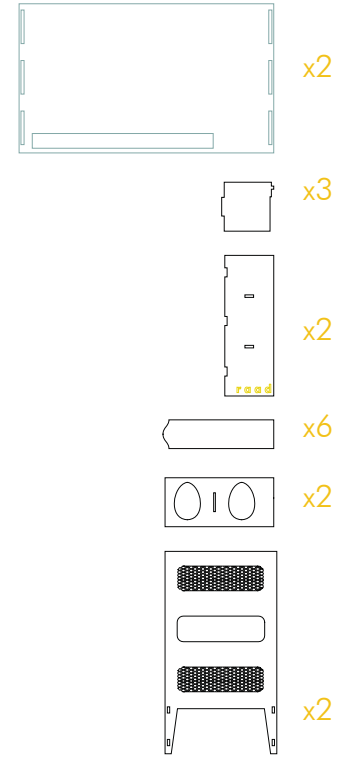
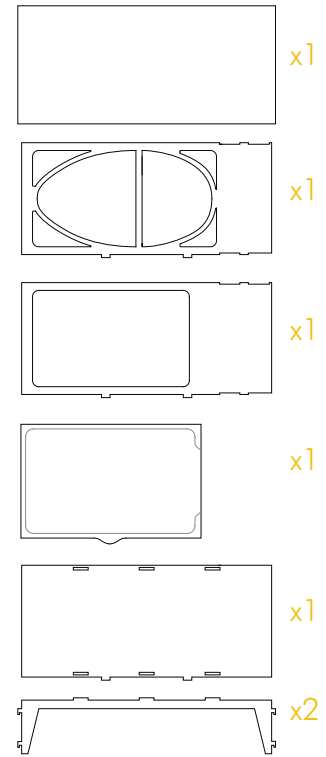

THE FLOOR PLAN

Each floor plan and structural piece is prefabricated off site, precision-cut with computer driven routers; then essembled into the all-inclusive Chicken Co-Op.

NESTROOMS: 4

RUN & DINING AREA : COMBINED

MEZZANINE

ROOSTING AREA

APPROX: SQ FT: 46

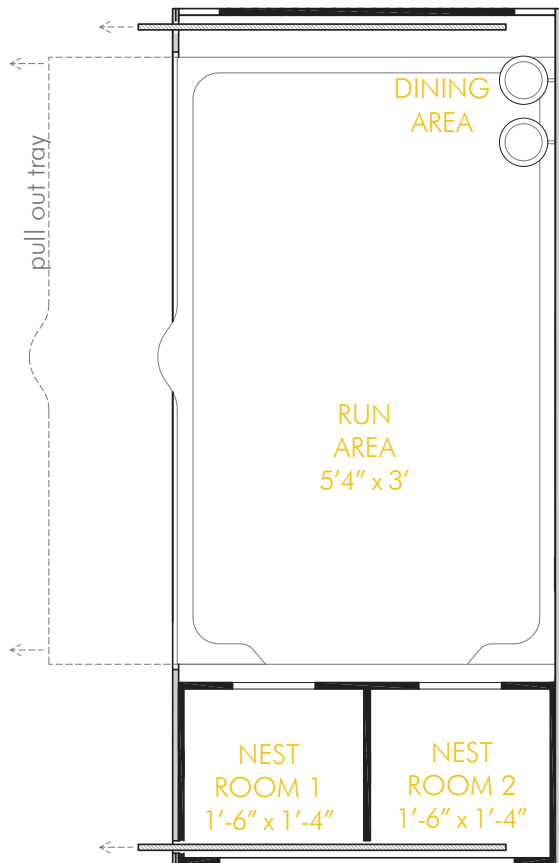

1ST FLOOR: LIVE
peck away in our en-suite
scratch n' run area.

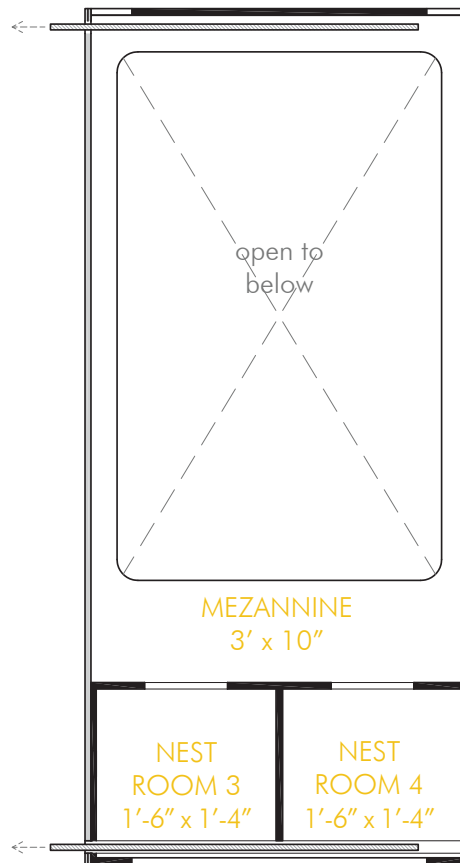

2ND FLOOR: WORK
spacious, spa-like offices for
laying eggs in comfort and
privacy

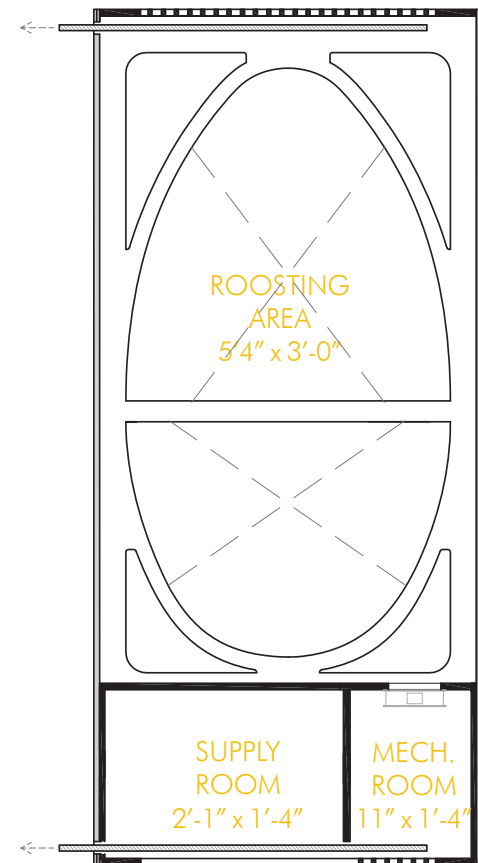

3RD FLOOR : PLAY
relax and hangout at our
luxurious Egg Lounge



THE AMENITIES

The Chicken Co-Op offers a new standard in living with the most modern and comfortable accommodations.

- *Floor to ceiling windows*
- *Plenty of Storage*
- *Complimentary Dining Area*
- *Solar powered fan for keeping cool in the summer*
- *4 very spacious private units with great views*
- *sliding tray for easy clean up*
- *white glove installation services upon request*
- *reliable customer service available*

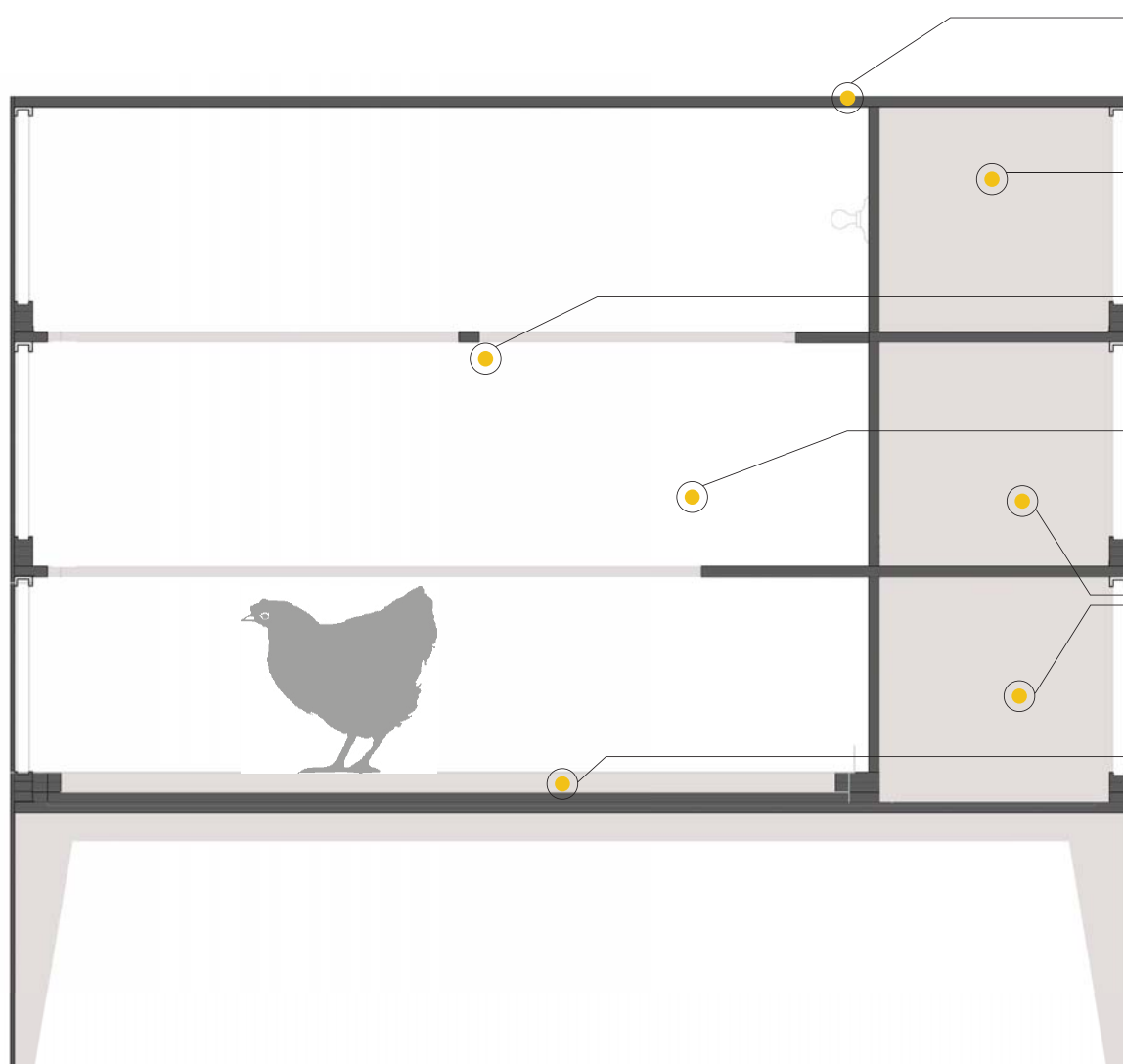

VENTILATION

a solar powered fan provides air circulation during the hot months.

STORAGE

a storage area provides space for all your chicken's bedding and dietary needs

PERCH

the Egg Lounge is elevated for the chicken's roosting preference.

VIEWING

acrylic panels provide windows into the lives of the birds.

EGGS

four private units for comfortable egg-laying. sliding panels provide access to the humans each morning.

CHICKEN RUN

wood shavings line main living space, that conveniently slides out for easy cleaning.



THE LUXURY

The Chicken Co-Op presents a unique luxury option for urban chickens. Floor to ceiling windows allow for unparalleled views. Amenities are fully integrated. Open, loft-like spaces liberate the lifestyles of modern chickens.

An adjustable ventilation system creates optimum comfort for chickens in any weather or climate. The four-nest chicken loft of 63 sf allows for spacious, comfortable living. Exclusive and social spaces combine, allowing chickens to interact with neighbors and retreat to luxurious private nests



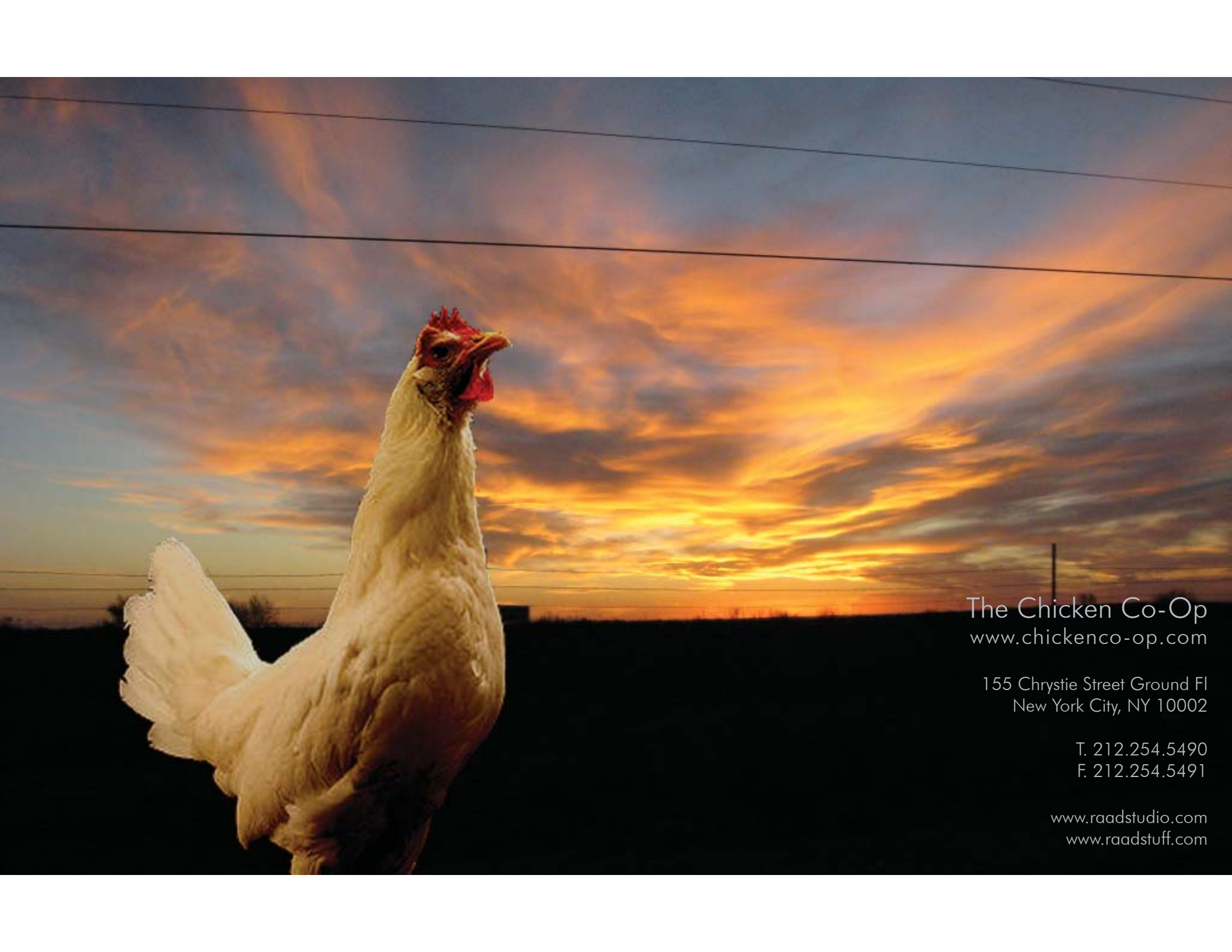

The Chicken Co-Op
www.chickenco-op.com

155 Chrystie Street Ground Fl
New York City, NY 10002

T. 212.254.5490
F. 212.254.5491

www.raadstudio.com
www.raadstuff.com